

CERTIFIED COPY – CANVASS OF VOTES

LAKE COUNTY, SOUTH DAKOTA
MARCH 29, 2016
BRANT LAKE MUNICIPAL INCORPORATION ELECTION

RECEIVED

APR 08 2016

S.D. SEC. OF STATE

Total number voting: 70

For Incorporation: 61

Against Incorporation: 9

CERTIFIED OFFICIAL RETURNS

Roberta Janke

Roberta Janke, Lake County Auditor
Dated this 30th day of March 2016.

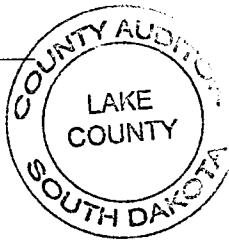

Filed this 8th day of April 2016
Shirley Krebs
CLERK OF STATE

STATE OF SOUTH DAKOTA)

)SS.

COUNTY OF LAKE)

We being the Board of Canvassers in Lake County for the Brant Lake (incorporation of a municipality) Election held in said County on the 29th day of March 2016 hereby certify that this is a true and correct abstract of the votes cast in Lake County at said election.

Dated this 5th day of April 2016.

BOARD OF LAKE COUNTY COMMISSIONERS.

Scott Pedersen

Scott Pedersen, Chairman

Roger Hageman

Roger Hageman, Vice Chairman

Dan Bohl

Dan Bohl, Commissioner

Ronald Golden

Ronald Golden, Commissioner

Kelli Wollmann

Kelli Wollmann, Commissioner

**Lake County Commissioners' Order
on the Application to Incorporate
the Municipality of BRANT LAKE, Lake County, South Dakota
REQUIRED PURSUANT TO SDCL 9-3-6**

WHEREAS, A Petition has been filed with the Lake County Commissioners which constitutes an application for the incorporation of the municipality of Brant Lake, Lake County, South Dakota, pursuant to SDCL 9-3-5, and

WHEREAS, Said Petition is signed by not less than twenty-five percent (25%) of the qualified voters who are either registered voters in the proposed municipality or landowners in the proposed municipality who are also registered voters of this State, and

WHEREAS, The Lake County Board of County Commissioners is satisfied that the requirements of Statute have been met and the required census of the population of Brant Lake having been duly taken and verified to by Affidavit, now therefore,

BE IT RESOLVED by the Lake County Board of County Commissioners as follows:

That the boundaries of the proposed municipality of Brant Lake shall be as follows:

Located in Lake County, South Dakota.

INCLUDING:

Government Lot 6 in Section 3, lying southwesterly of the railroad right-of-way, except those platted areas, Section 3, Township 105 North, Range 51 West of the 5th P.M., Lake County, South Dakota

Lots 2A, 2B and 3B of Brant Groves Addition in the NW1/4 of Section 3, Township 105 North, Range 51 West of the 5th P.M., Lake County, South Dakota

Lots 5 and 6 Brant Groves Addition in the NW1/4 of Section 3, Township 105 North, Range 51 West of the 5th P.M., Lake County, South Dakota

Lots 7 thru 15, inclusive, in the Plat of Lot 2 and Lots 7 thru 15 (inclusive) all in Brant Groves Addition in the NW1/4 of Section 3 Township 105 North, Range 51 West of the 5th P.M., Lake County, South Dakota

Lot 16 of Brant Groves Addition in the NW1/4 of Section 3, Township 105 North, Range 51 West of the 5th P.M., Lake County, South Dakota

Lot 1 of Merlin's Addition in the NW1/4, Section 3, Township 105 North, Range 51 West, 5th P.M., Lake County, South Dakota

Lot 7 of the Arbor Lane Second Addition in the NW1/4, Section 3, Township 105 North, Range 51 West, 5th P.M., Lake County, South Dakota

Lot 8X of the Arbor Lane Fifth Addition in the NW1/4, Section 3, Township 105 North, Range 51 West, 5th P.M., Lake County, South Dakota

Tract A of Pedersen's Addition in the NW1/4, Section 3, Township 105 North, Range 51 West, 5th P.M., Lake County, South Dakota

Tract B of Pedersen's Addition in the NW1/4, Section 3, Township 105 North, Range 51 West of the 5th Principal Meridian, Lake County, South Dakota

Tract C of Pedersen Addition in the NW1/4 of Section 3, Township 105 North, Range 51 West of the 5th P.M., Lake County, South Dakota

Tract 1 thru Tract 13 of Cove's North Addition, inclusive, in Section 3, Township 105 North, Range 51 West of the 5th P.M., Lake County, South Dakota

Tracts A, B, C, and D of Brant Lake Hills Tenth Addition, being a subdivision of that part of Gov't Lot 6 in Section 3, Township 105 North, Range 51 West of the 5th P.M., lying southwesterly of the railroad right-of-way, Lake County, South Dakota

Lots 3 thru 7 of Brant Lake Hills Second Addition, inclusive, being a subdivision of that part of Gov't Lot 6 in Section 3, Township 105 North, Range 51 West of the 5th P.M., Lake County, South Dakota

Lots 8 thru 10 of Brant Lake Hills Third Addition, inclusive, being a subdivision of that part of Gov't Lot 6 in Section 3, Township 105 North, Range 51 West of the 5th P.M., Lake County, South Dakota

Lot 11 of Brant Lake Hills Fifth Addition, being a subdivision of that part of Gov't Lot 6, in Section 3, Township 105 North, Range 51 West of the 5th P.M., Lake County, South Dakota

Lots 12 and 13, Brant Lake Hills Sixth Addition, being a subdivision of that part of Gov't Lot 6, in Section 3, Township 105 North, Range 51 West of the 5th P.M., Lake County, South Dakota

Lots 14, 15, and 16 of Brant Lake Hills Seventh Addition, being a subdivision of that part of Gov't Lot 6, in Section 3, Township 105 North, Range 51 West of the 5th P.M., Lake County, South Dakota

Lots 17A and 21A of Brant Lake Hills Eleventh Addition, being a subdivision of that part of Gov't Lot 6 in Section 3, Township 105 North, Range 51 West of the 5th P.M., lying southwesterly of the railroad right-of-way, Lake County, South Dakota

MAR 31 2016

BOUNDARY MAP CITY OF BRANT LAKE

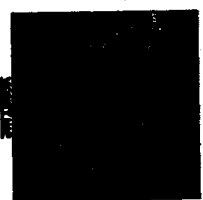
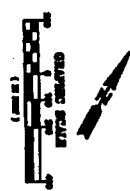
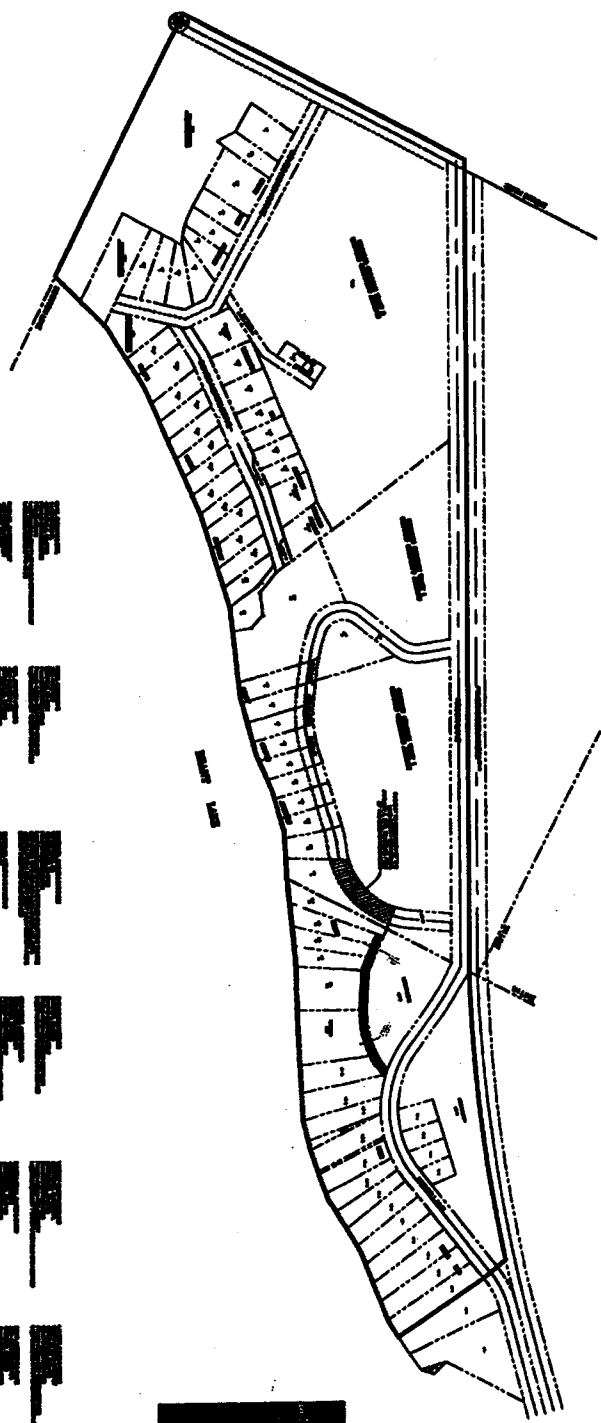

[REDACTED]



South Dakota Secretary of State
SHANTEL KREBS

Return To: PAULA WAGNER
3871 BRANT GROVE DRIVE
CHESTER, SD 57016

From: Secretary of State Shantel Krebs
Corporations Division

Filing Date: 04/08/2016

Re: BRANT LAKE, SOUTH DAKOTA (CI000255)
Corporation Miscellaneous

The documents on behalf of BRANT LAKE, SOUTH DAKOTA have been received and filed. Attached is the Certificate along with a receipt for the filing fee of \$. Below is a summary of the transaction.

Remitter	Address	Amount Paid
PAULA WAGNER	3871 BRANT GROVE DRIVE CHESTER, SD 57016	
Total:		

Description	Invoice Date	Qty	Receipt #	Subtotal
Corporation Miscellaneous		1	403820	
Total:				